

# Berkeley mini Math Tournament 2026

## Tournament Guide

*We're excited to have you here! This is your guide to all things tournament day.*

- For any directions, questions, or concerns, ask a BmMT staff member (we're wearing **dark green** shirts!), or come to our info desk, located between Dwinelle Hall and Wheeler Hall.
- You will be assigned a testing room upon checking in, which can be found on your name tag. **Do not enter this room, or any room, until the door is propped open and there is a BmMT proctor inside.**
- Live announcements will be posted on our website (<https://live.berkeley.mt>).

## Schedule of Events

Time	Event	Location
8:00 AM	Check-in <i>(coaches only)</i>	After arrival, coaches should proceed to one of the two auditoriums in Dwinelle Hall, depending on whether they have already checked in online or not. <b>Check-in</b> <i>(if haven't checked in online)</i> – Dwinelle 145 <b>Materials Pick-up</b> <i>(if checked in online)</i> – Dwinelle 155
9:00 AM	Puzzle & Individual Rounds	Classrooms in Dwinelle Hall, Wheeler Hall, VLSB, and Pauley Ballroom. Students will be assigned a room at check-in. <b>Pre-ordered Lunch Pick-up</b> <i>(11:30 – 12:15, coaches only)</i> └ Outside Dwinelle Hall
12:00 PM	Lunch	<b>T-shirt &amp; Tote Bag Sales, Free Sponsor Merch</b> <i>(while supplies last)</i> └ Outside Dwinelle Hall <b>Problem Disputes</b> <i>(Puzzle, Individual)</i> – Dwinelle 234
1:15 PM	Team & Relay Rounds	Classrooms in Dwinelle Hall, Wheeler Hall, VLSB, and Pauley Ballroom. Students will be assigned a room at check-in.
3:30 PM	Activities	<b>Activities</b> – See descriptions on the back of this page. <b>Tiebreaker</b> <i>(by invite only*)</i> – Dwinelle 229 <b>Problem Disputes</b> <i>(Team, Relay)</i> – Dwinelle 234
5:00 PM	Awards Ceremony	The Awards Ceremony will take place simultaneously in Dwinelle 145, Dwinelle 155, VLSB 2040, and VLSB 2050, and Pauley Ballroom. Students will be assigned an awards room at check-in. <i>Going to a different room may result in your awards being delayed.</i>

*\*Tiebreaker qualifiers will be posted on the website, sent to coaches via email, and announced after Relay.*

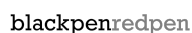

## Student Activities (3:30 PM)

### Time Mix-up Puzzle Hunt by HRT & BMT

Pauley Ballroom

Ready to unleash your puzzle-solving skills? Join our puzzle hunt! You and a team of Time Un-mixers will embark on one of the adventures of all time, and earn cool prizes along the way. Will you and your team save the clocks, or will you get stuck spinning your gears? No prior experience with puzzles is needed, just bring an open mind and your problem solving brain!

### Mathematician Mash

Dwinelle 145

Test your math intuition in this fast-paced game, inspired by the classic game show Family Feud! Teams will try to guess the most popular answers to math-themed questions. The goal isn't just to be correct—it's to think like everyone else and guess the most common answers. Work with your teammates, buzz in quickly, and see if your mathematical instincts can lead your team to the top!

### Estimathon

Dwinelle 155

Got wit and strategy? Come to our Estimathon®, a contest combining trivia, strategic planning, and sharp mathematical thinking. Teams of up to 3 will race against the clock to tackle a challenging set of 13 Fermi-style problems, testing their ability to think fast and outsmart the competition.

### Float Your Boat: Archimedes Challenge

Dwinelle 106, 109

In 250 BCE, Archimedes discovered the principle of buoyancy, noticing it in his bathtub and using it to prove the king's crown wasn't made of pure gold! Can you use it to keep heavy boats afloat? Come experiment with the physics that keeps everything from toy rafts to cargo ships above water.

### Board Game Lounge

Dwinelle 258

Looking for a place to chill out after a long day of testing? Come to the Board Game Lounge! We'll have a variety of games (and seats) for students, parents, and coaches to unwind.

### Origami

Dwinelle 246, 247

Want to take home a cute souvenir from BmMT, or build a beautiful spiky ball with us? We've got a variety of paper patterns and instructions — we'll teach modular origami, beginning from the basics! No prior craft experience is needed!

### Plank Countdown

Dwinelle 182, 183, 187

Miss the excitement of the MATHCOUNTS® Countdown Round? Want to show off mental math in a countdown match... while planking? If you'd enjoy that exciting and silly experience, come join us for our Plank Countdown tournament!

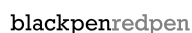

## Parent Activities

We will have the following selection of activities for coaches and parents, in addition to our parent lounge in Dwinelle 155, which will be open from 9:00 AM to 3:00 PM.

### A Closer Look at Problem Solving in Math Contests by Isaac Li

9:00 AM – 11:00 AM, Dwinelle 155

What makes a math contest problem good? How can contests offer students a gateway to deep and compelling mathematical investigations? In this talk, curriculum developer Isaac Li will draw on his experience as a mathlete and contest writer to explore how contests, at their best, can encourage students to persist through difficulty, approach problems more strategically, and develop agency over their own learning.

*Isaac Li is a math curriculum developer at Art of Problem Solving. He has served as a test organizer for the Berkeley Math Tournament and contributed problems to the USA Mathematical Talent Search (USAMTS), among other competitions.*

### Campus Tours

11:00 AM, Dwinelle 155

Join us on a tour of the beautiful UC Berkeley campus and explore the university's 150-year long history! To join this activity, please sign up in the parent lounge (Dwinelle 155) after the talk by Isaac Li.

### Dr. Po-Shen Loh Table

11:00 AM, Dwinelle 155

Come chat with Dr. Po-Shen Loh, professor of mathematics at Carnegie Mellon University! Loh has earned many accolades over his career, in addition to serving a decade-long term as the national coach of the USA International Mathematical Olympiad team.

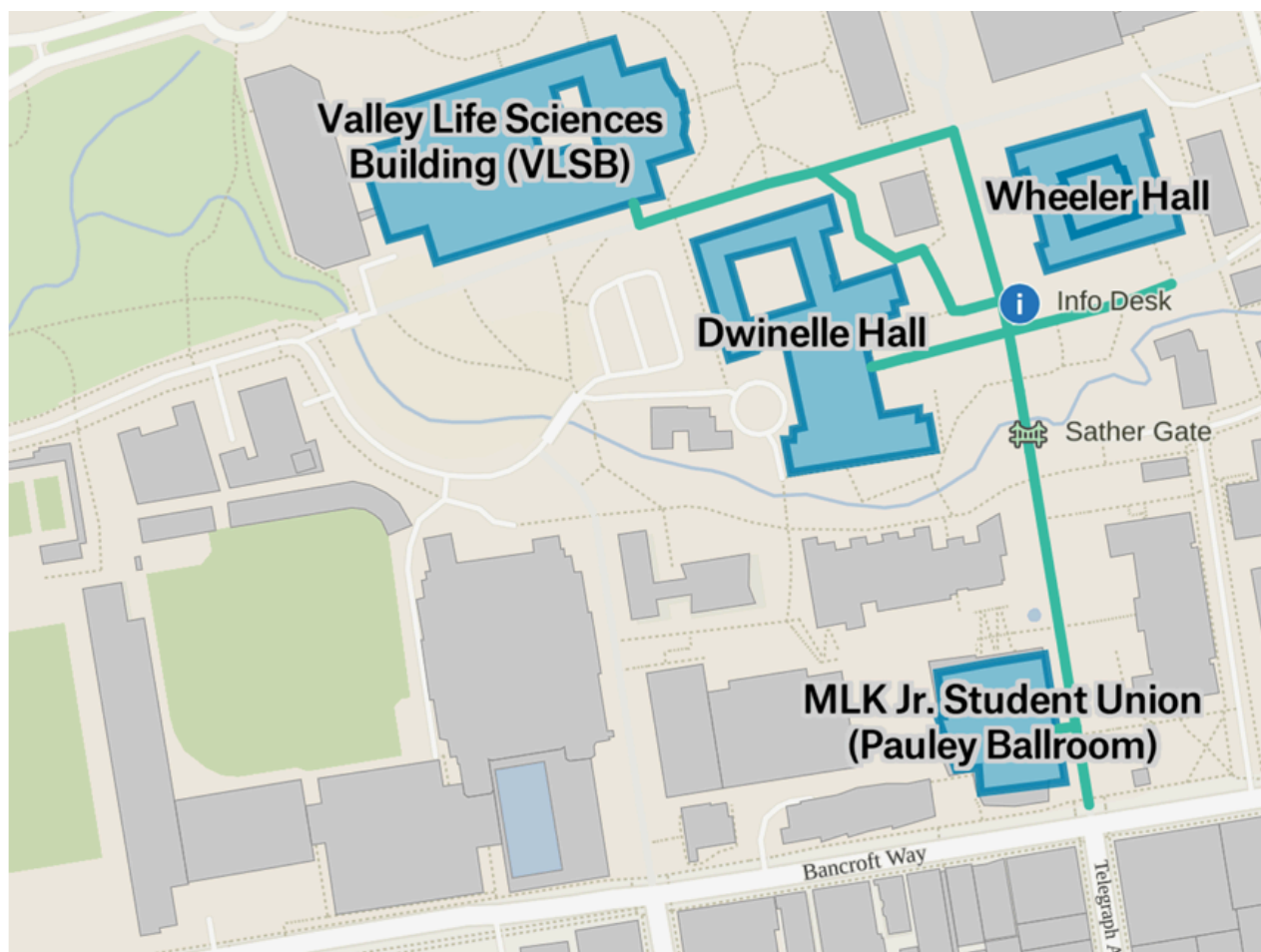

# Directory

## Dwinelle Hall

- **Floor E**
  - Gender-neutral Restrooms: 220, 273
  - Testing: 228 - 263
- **Floor D**
  - Auditoriums: 145, 155
  - Disputes\*: 234
  - Testing: 104 - 109, 111, 182 - 187, 189, 130 - 134
- **Floor C**
  - Men's Restrooms: 54
  - Women's Restrooms: 56
  - Testing: 79, 83, 87 - 89

\* See schedule for more details.

## Valley Life Sciences Building (VLSB)

- **Floor 2**
  - Awards: 2040, 2050
  - Men's Restrooms: 2056
  - Gender-neutral Restrooms\*\*: 2052
  - Testing: 2030 - 2038, 2062 - 2070

\*\* Women's restrooms are located on Floor 1 near the center of VLSB.

## Wheeler Hall

- **Floor 2**
  - Men's Restrooms: 226C
  - Women's Restrooms: 226B
  - Gender-neutral Restrooms: 226D
  - Testing: 200 - 204, 220 - 224
- **Floor 1**
  - Men's Restrooms: 128
  - Women's Restrooms: 127
  - Testing: 102 - 104, 108, 120, 124 - 130
- **Basement**
  - Men's Restrooms: 25
  - Women's Restrooms: 26
  - Testing: 20 - 30

## Pauley Ballroom (MLK Jr. Student Union)

- **Floor 3**
  - Pauley Ballroom
  - Restrooms are located up or down one floor (Floors 2 and 4)

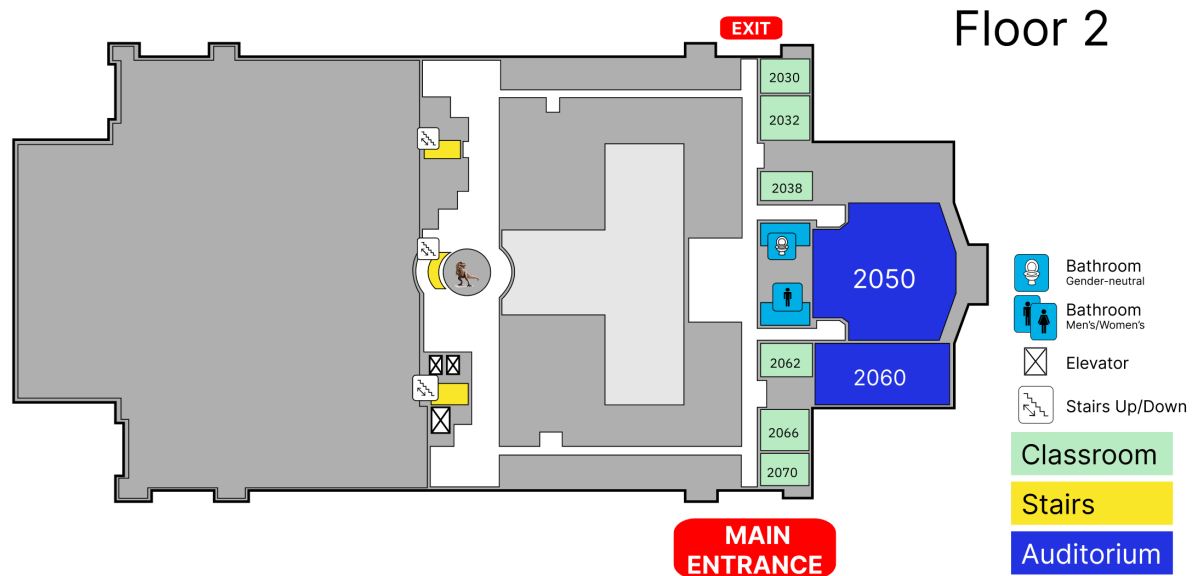

## Valley Life Sciences Building

for use only at the Berkeley mini Math Tournament 2026  
adapted from materials provided by the College of Letters and Sciences Facilities Office

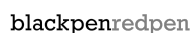

# Dwinelle Hall

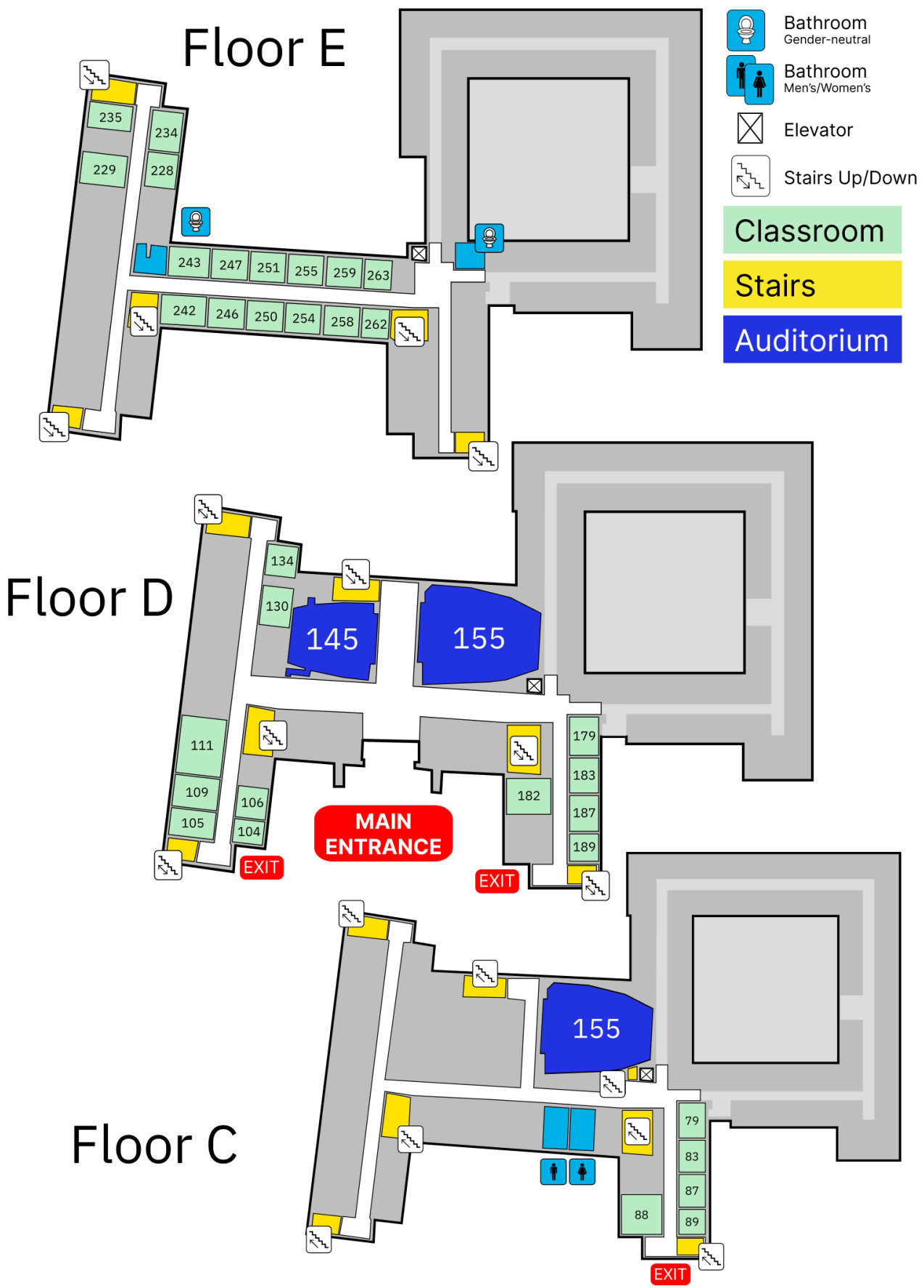

# Wheeler Hall

